

Spare parts ACTUSMART (ex)(r)CM12 FS(L)

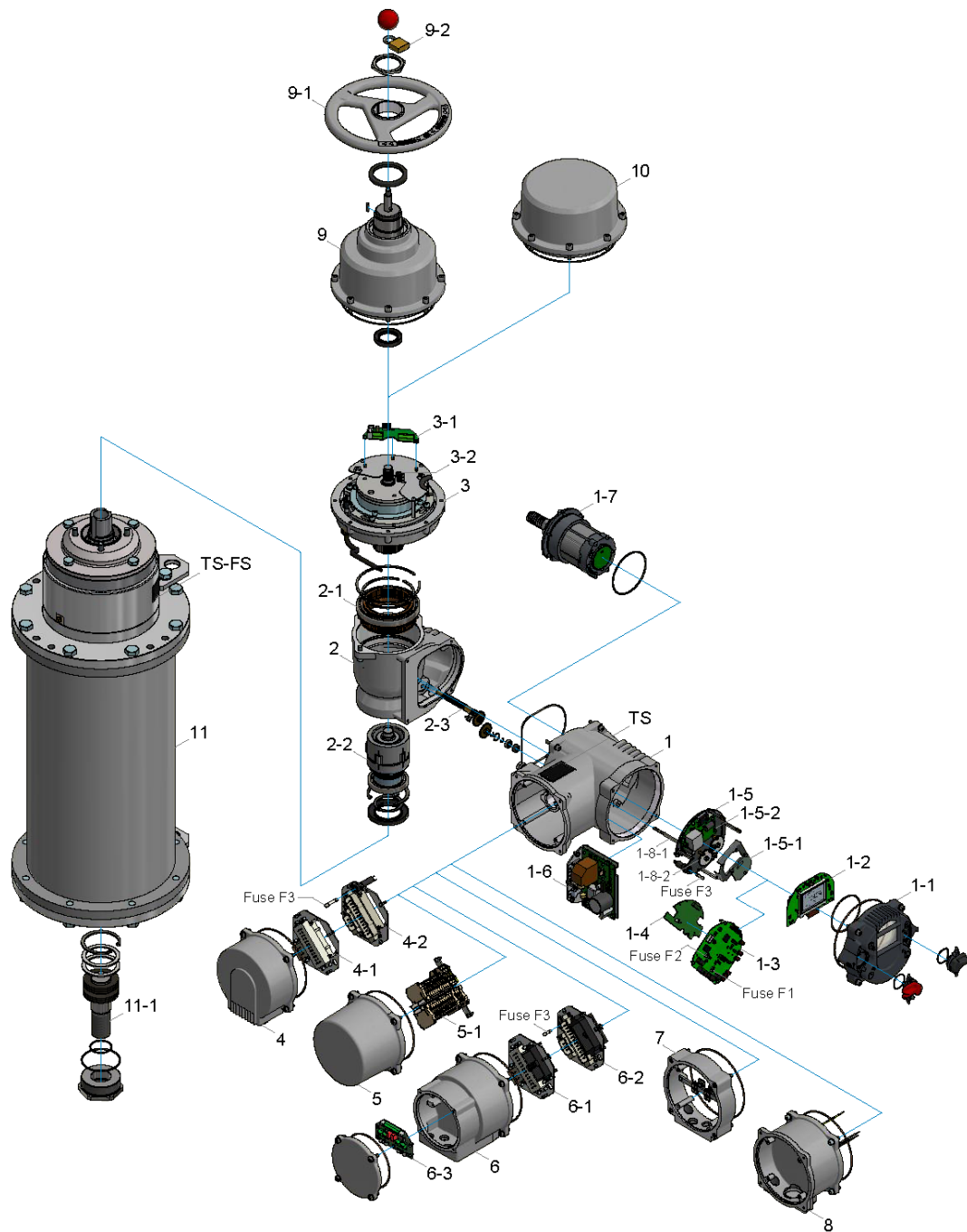

**CAUTION:** When ordering spare parts, you **must** provide the **serial number** (look type shield or status menu S6).

Use only original spare parts supplied by SCHIEBEL. Using other parts will render the warranty void. Illustrations may differ from actual spare parts.



Asm.	No.	Description
1		E-case
	1-1	Control unit cover
	1-2	Display circuit board
	1-3	Logic circuit board
	Fuse-F1	Micro fuse 1A
	Fuse-F2	Micro fuse 4A
	1-4	Expansion board (bus, relay)
	1-5	Multiturn sensor assembly
	1-5-1	Multiturn sensor
	1-5-2	24VDC Step-Down Converter
	1-6	BLDC Power Electronics
	Fuse-F3	Fuse 5A
	1-7	Motor
	1-8-1	Sensor shaft
	1-8-2	Gear
2		Mech. case
	2-1	Worm gear
	2-2	Output shaft
	2-3	Helical cut pinion gear
3		Failsafe Brake Assembly
	3-1	Failsafe PCB
	3-2	Switch for Manual Mode
4		Plug cover
	4-1	Plug frame customer side (socket)
	4-2	Plug frame actuator side (pins)
5		Terminal box cover
	5-1	Terminal block
6		Entire bus plug cover with plugs & circuit board
	6-1	Bus plug frame customer side (socket)
	6-2	Bus plug frame actuator side (pins)
	6-3	Bus connection board
7		Additional ring bus (Ex)
8		400V module
TS		Type plate

Asm.	No.	Description
9		Handwheel Cover
	9-1	Handwheel
	9-2	Padlock
10		Failsafe Brake Cover
11		Failsafe Unit
	11-1	Spindle Pin
TS-FS		Type plate Failsafe Unit